

DMSS APP SET UP PAGE 1

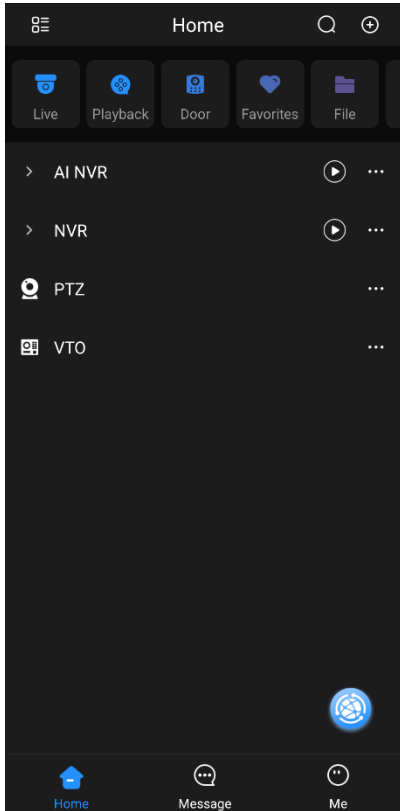

1. Tap on the + icon

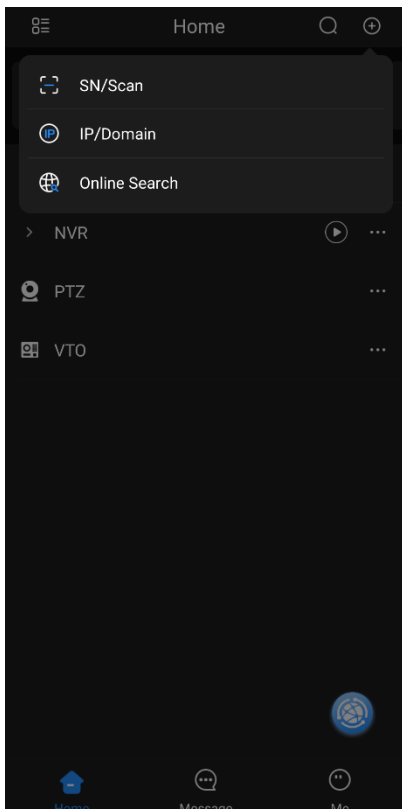

2. Tap on **SN/Scan**

DMSS APP SET UP PAGE 2

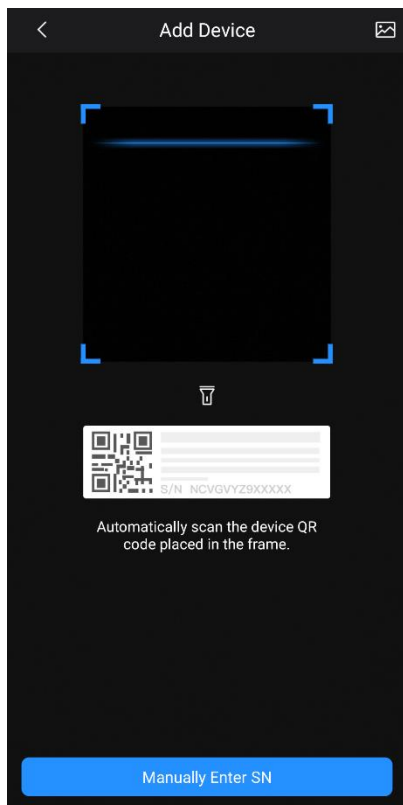

3.

Scan the QR code for your Device's Serial Number, then click **Next**

Info

The QR code can be found at **Main Menu > Network > P2P (or Easy4IP)** on a recorder **AND** on the box the device came in.

If you don't have a QR code, tap the **Manually Enter SN** button and enter the serial number of your device manually.

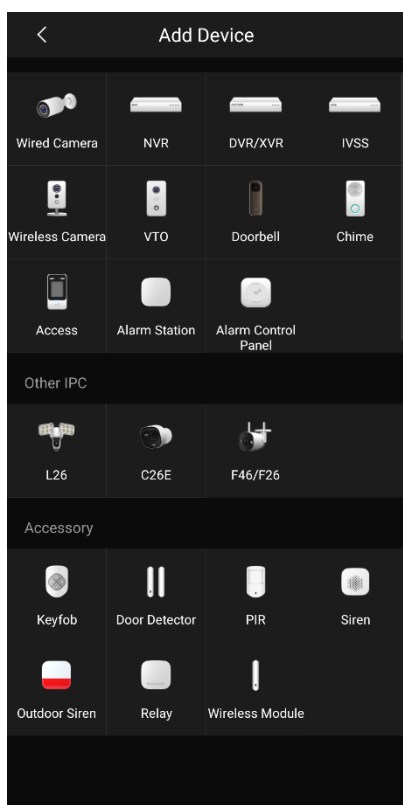

4.

Tap on the **type of device** you wish to add.

Info

NVR for an NVR for a recorder with IP cameras
DVR/XVR for a recorder with CVI cameras
VTO for a Door Station
Wired Camera for a standalone Camera wired to a switch

DMSS APP SET UP PAGE 3

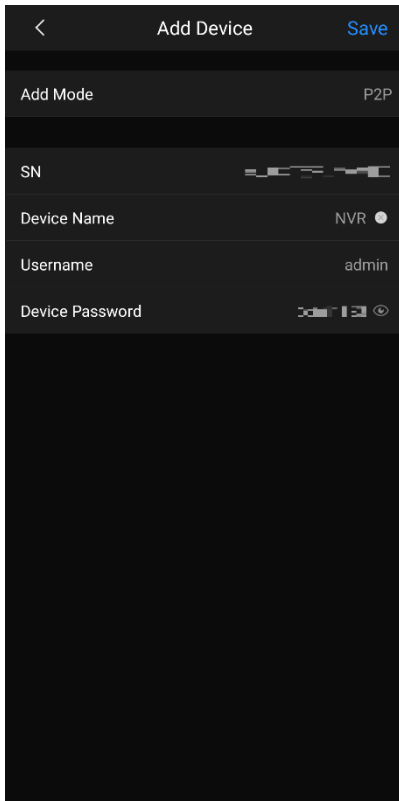

5.

- 1) **Name** your device
- 2) Enter the admin account's **password**
- 3) Tap **Save**